

# LHR SERIES

## Structure

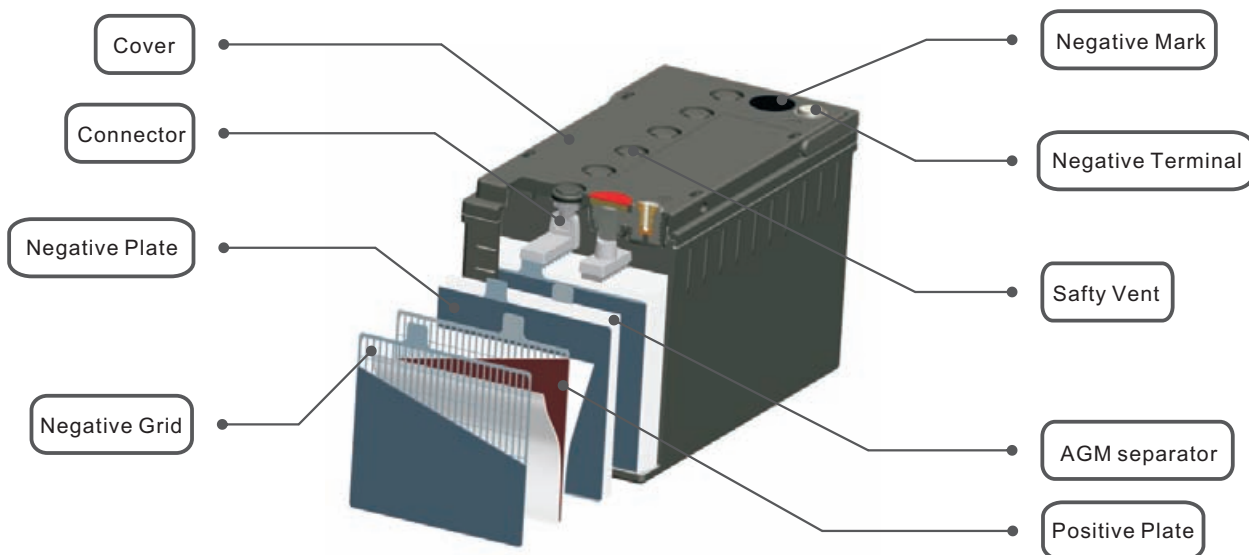

## Terminal

### T2

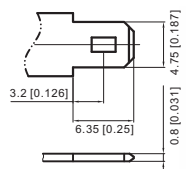

### T2

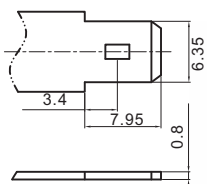

(mm)

### T6

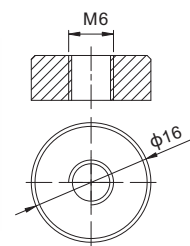

Torque: 3.9 ~ 5.4 (N\*m)  
(mm)



### T11

Torque: 11 ~ 14.7 (N\*m)  
(mm)

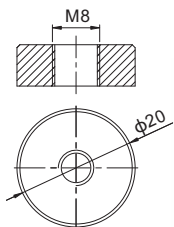

### T12

Torque: 2.0 ~ 3.0 (N\*m)  
(mm)

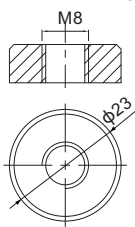

### T18

Torque: 11 ~ 14.7 (N\*m)  
(mm)

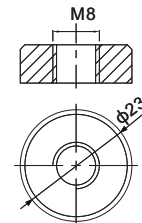

LEOCH factory

LEOCH sales office

Customers

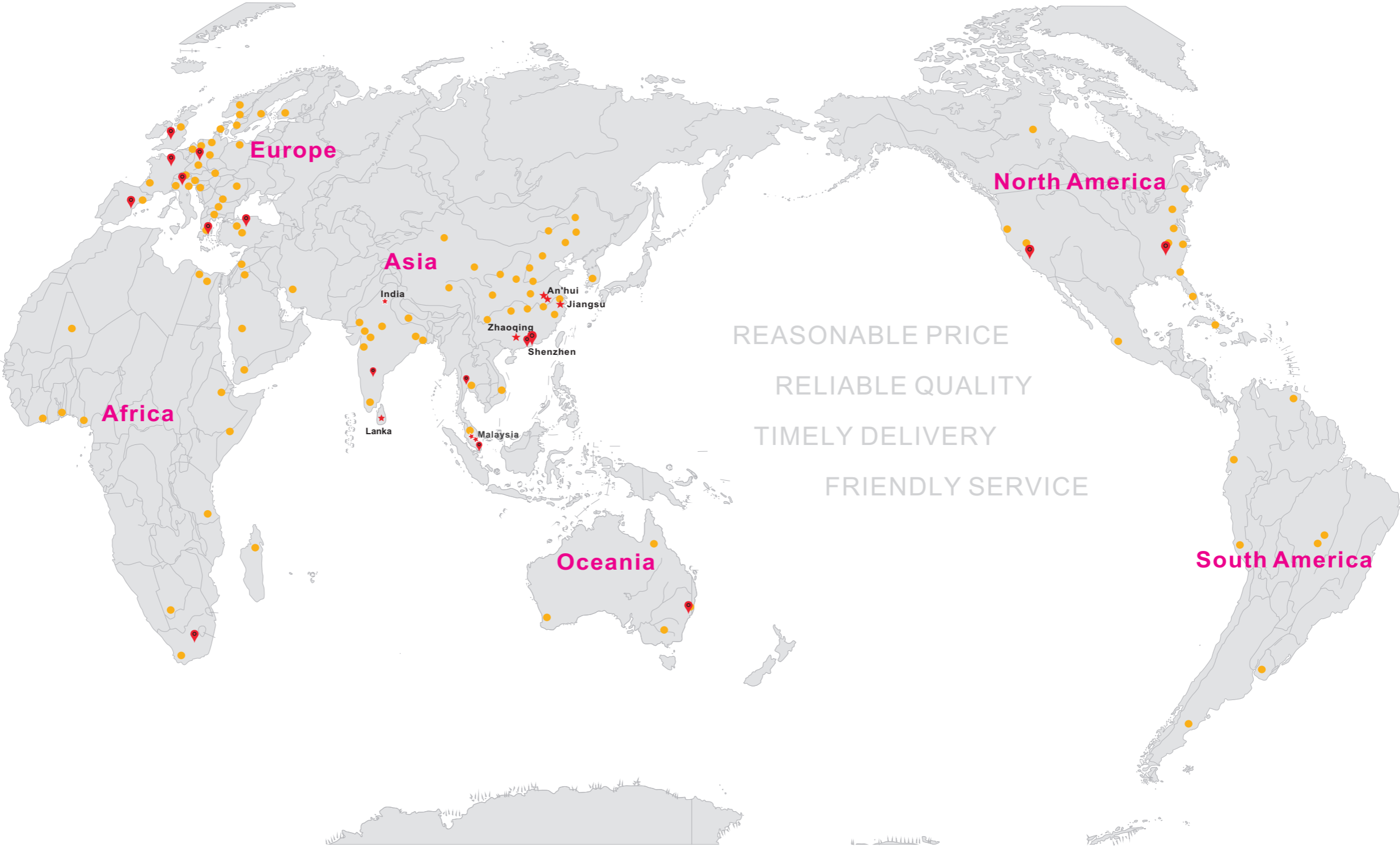

REASONABLE PRICE

RELIABLE QUALITY

TIMELY DELIVERY

FRIENDLY SERVICE